

kronotex

FLOORS FOR LIVING



‘LIFE CAN BE SO CHIC,



traditional V-groove



sound reduced



EXQUISIT

8+1mm SOUND DESIGN



8 x

1380 x 193 x 8+1mm

2,131 m²

~ 16 kg

54.33 x 7.59 x 0.314+0.039"

22.94 sq.ft

33 lbs approx.

AC4 / 32

WOHNEN | DOMESTIQUE | LIVING | ЖИЛЬЯ



EN 685

23



acc. to Kronotex guarantee

GEWERBLICH | PROFESSIONNEL | COMMERCIAL | КОММЕРЧЕСКОЙ



EN 685

32



acc. to Kronotex guarantee

DIN EN 13329

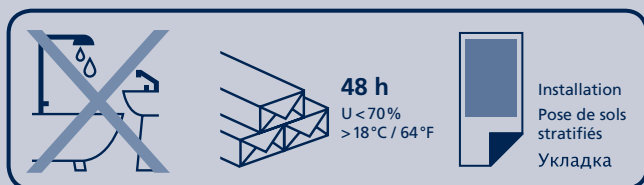

48 h
U < 70%
> 18°C / 64°F

Installation
Pose de sols
stratifiés
Укладка



Made in Germany
KRONOTEX.COM



6039.3

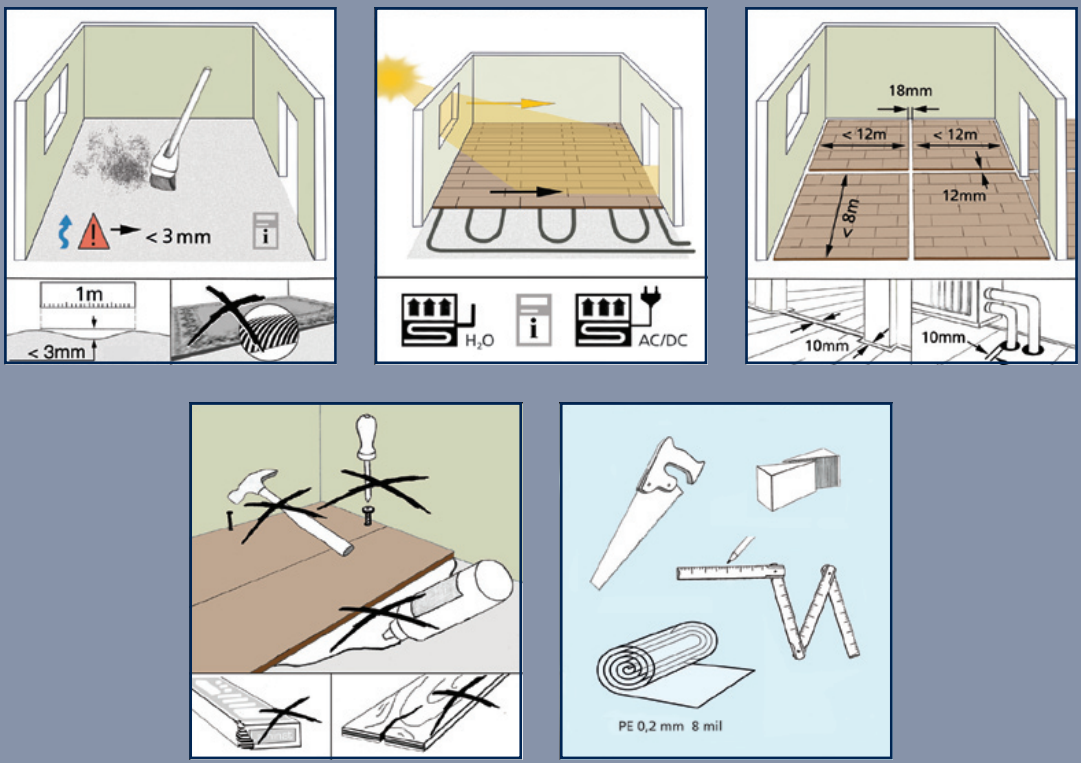

INSTALLATION

1. PE 0,2 mm underlayment is laid over the prepared surface. A circular detail shows a 20 cm diameter hole. A diagram below shows the underlayment with arrows indicating its placement.
2. The first Kronotex plank is laid across the room. A diagram shows a 10 mm gap from the wall.
3. The second Kronotex plank is laid, overlapping the first. A diagram shows the overlapping joint.
4. The third Kronotex plank is laid, continuing the row. A diagram shows the joint between planks.
5. The fourth Kronotex plank is laid, showing a 12° bevel and a length of $> 400\text{mm}$. A diagram shows the 12° bevel.
6. The fifth Kronotex plank is laid, showing a 12° bevel. A diagram shows the 12° bevel.
7. The sixth Kronotex plank is laid, showing a "Clic" sound as the planks interlock. A diagram shows the interlocking joint.
8. The seventh Kronotex plank is laid, showing the final row. A diagram shows the final row.
9. The eighth Kronotex plank is laid, showing a 10 mm gap from the wall. A diagram shows the 10 mm gap and a $> 50\text{mm}$ gap between the wall and the plank.
10. The ninth Kronotex plank is laid, showing a 10 mm gap from the wall. A diagram shows the 10 mm gap and a door opening.
11. The tenth Kronotex plank is laid, showing a hole for a pipe. A diagram shows a hole with diameter $\varnothing x$ and a hole with diameter $\varnothing x + 20\text{mm}$.
12. The eleventh Kronotex plank is laid, showing a warning sign and an information icon. A diagram shows a warning sign and an information icon.
13. The twelfth Kronotex plank is laid, showing a temperature range of 20 - 22 °C and a humidity range of U 50 - 60%. A diagram shows a thermometer and a humidity gauge.
14. The thirteenth Kronotex plank is laid, showing a Type "W" soft / souple / blando / мягкий floor. A diagram shows a Type "W" floor and a warning sign.

REMOVAL

